

Fixed or portable, this massive stand enables a stable location for sockets and chargers. Ideal for lobbies, waiting rooms, and receptions, or where power cables come from the floor. Fixed is used in spaces with double floors, providing a direct inlet for cables from the floor. When used in this

way, in addition to power sockets, it can be further equipped with data modules. The portable version, with a large stand ensuring a stable upright position, is used to provide power sockets and fast chargers, with or without switches for each group of sockets, but without data modules.



**ADVANTAGES**

- Flexible use
- Very stable
- Ideal when power comes from the floor

**POWER CHARACTERISTICS**

- **Voltage:** 100-250 V max
- **Current:** 16 A max
- **Frequency:** 50-60 Hz
- **Temperature:** 0 – 40°C
- **Relative humidity:** 0 – 95 % (no condensing)
- **Protection:** IP 20
- **Power cable / connector:** cable HO5VV - F, 3x1,5mm<sup>2</sup> EPN 1104/EPN 1114 (Wieland m/f) – 400mm. For additional cables, (Table 5, page 56)

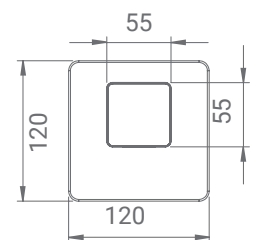
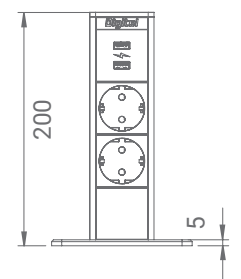
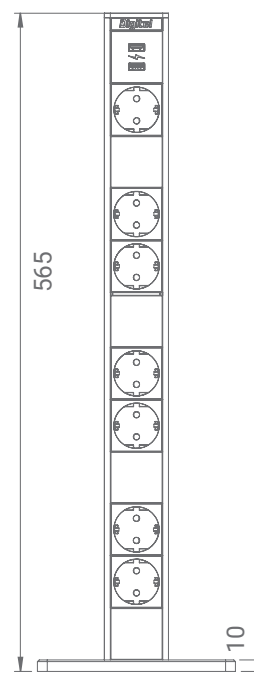
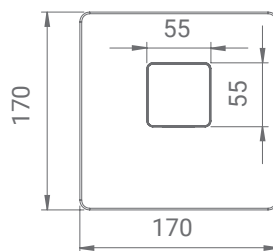

**COLOURS**

Plastic parts

RAL 9010

RAL 9005

Aluminum

natural anodized aluminum

By request: CH, DM, USA, FR, IT, GB - Multistandard power socket (Table 4 page 56), Red - Power supply from the aggregate, Green - Power supply from BACK UPS, USBCharger2, 5V, 2.4A, 2 ports

Installing of power modules is performed solely in our company.

We offer our clients the choice between having their devices equipped with communication and data modules in our company or for the client to order and buy the required modules and install them themselves.